

WE JUST DON'T
BUILD
BUILDINGS
WE BUILD
Relationships



BORA *Residency*

A P R O J E C T B Y B O R A A S S O C I A T E S



"BOBA RESIDENCY" WITH NATURE

Assumptions & Specifications

- ✦ R.C.C. framed structure with brick masonry
- ✦ White terrazzo flooring in living and green mosaic tiles flooring in all rooms.
- ✦ Full glazed tiles to Bath/Toilets and white glazed tiles in WC.
- ✦ Marble kitchen platform with 2.0 HT Glazed tiles dado.
- ✦ Aluminum sliding window with grill
- ✦ Decorative maindoor, internal flush doors.
- ✦ TV antenna & Telephone point in living rooms.

Special Features

- ✦ Maintenance free lift facility
- ✦ Ample space for parking with decorative flooring
- ✦ Children park
- ✦ Well developed building premises with flower beds
- ✦ Beautiful elevation with attractive colour scheme
- ✦ Society office, watermeter room

Ground Floor Plan

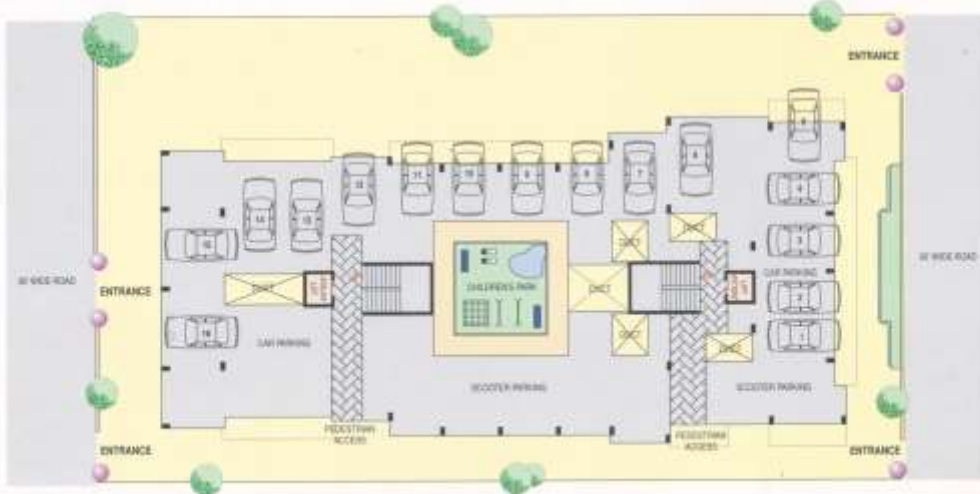



Typical Floor Plan (Still / First / Second / Third)



"BORA RESIDENCY" WITH LUXURY

AREA STATEMENT

FLAT NO.	SALEABLE AREA	TOP TERRACE
1, 4, 5, 8, 9, 12, 13, 16	810	—
17, 20, 21, 24, 25, 28, 29, 32	600	—
18, 19, 22, 23, 26, 27	800	—
30, 31,	1052.5	810

FLAT NO.	SALEABLE AREA	TOP TERRACE
2, 6, 10,	875	—
14	1206.25	925
3, 7, 11	947	—
15	1172	800

AREA IN SQ. FT.

Site Address : C.T.S. No. 73, Aundh, Pune : 411 007.



Note : The plans, specifications, photographs and dimensions in the brochure are indicative and are subject to change with out any prior notice.

Credits :

Architects :
Elbne - Bhade & Associates
560 Laxmi Road, Pune : 411 030.
Tel.: (0212) 491567

R.C.C. Consultants :
Sachin Associates
212 Savarnarekhu Building,
Prabhat Road, Pune : 411 004.

Legal Advisor :
Kantilal K. Sancheti (Advocate)
Neel Sadan, 1426 Sakshiv Peth,
Pune : 411 030.
Tel.: (0212) 480497

Developers :
NAMO CONSTRUCTION CO
701 Deccan Gymkhana,
Near Garware Bridge,
Pune : 411 004.
Tel.: (0212) 324478



Booking Contact:
BORA ASSOCIATES
Promoters & Builders
701 Deccan Gymkhana,
Near Garware Bridge, Pune : 411 004.
Tel.: (0212) (O) 324478, (R) 335122

Designed & Produced by Elbne Bhade Pvt. Ltd. www.elbne.com