

Your long-cherished dream comes true!



B O R A
PRIDE

AT BIBWEWADI ROAD, PUNE



◆◆◆
STILT FLOOR PLAN

Area Statement in sq.ft.

Type	Flat No	Built-up	Terrace	Garden	Store room	Total
Duplex	1	1956.00	192.00/2	500/4	220/2	2287.00
3BHK	2	1290.00	124.00/2	—	220/2	1462.00

◆◆◆
FIRST FLOOR PLAN

Area Statement in sq.ft.

Type	Flat No	Built-up	Terrace	Total
2BHK	3	1108.00	248.00/2	1232.00





◆◆◆
SECOND FLOOR PLAN

Area Statement in sq.ft.

Type	Flat No	Built-up	Terrace	Total
2BHK	4	1012.00	108.00/ 2	1066.00
2BHK	5	1108.00	124.00/ 2	1170.00



◆◆◆
THIRD FLOOR PLAN

Area Statement in sq.ft.

Type	Flat No	Built-up	Terrace	Total
2BHK	6	1012.00	56.00/ 2	1040.00
2BHK	7	1108.00	248.00/ 2	1232.00





For Booking Contact:

BORA ASSOCIATES
Promoters & Builders

701, Deccan Gymkhana, Near Garware
Bridge, Pune : 411 004.
Tel : (O.)553 4478/ 553 0896, (R.) 543 5122.
Email : gautambora@entireindia.com
Website : Entireindia.com/boraassociates

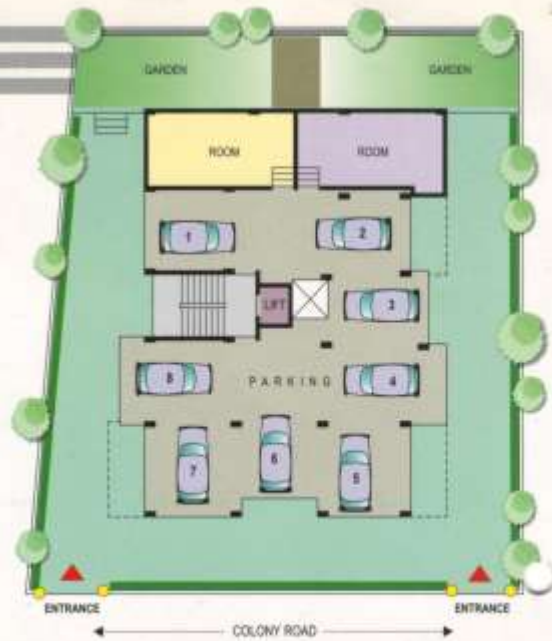

**SITE- Bora Pride, Plot No 10, Padma Society,
Bibwewadi Road, Pune-411 037.**

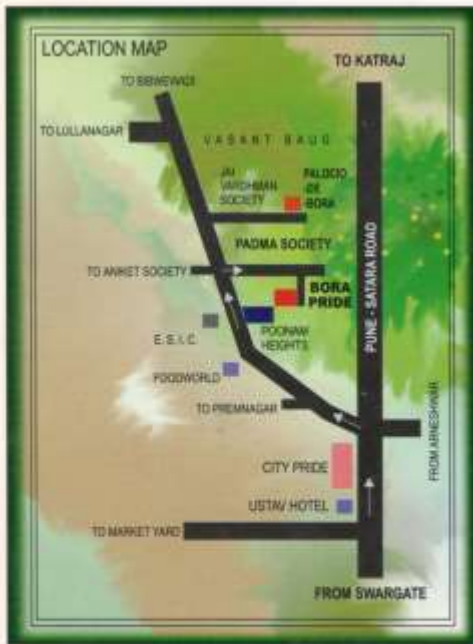

AMENITIES & SPECIFICATIONS

- Structure** : Earthquake resistant R.C.C. frame structure with brick masonry
- Flooring** : For Hall & Kitchen Dining - High Glazed ceramic tiles (16"x16"). For all rooms & terraces - 12"x12" ceramic tiles in plan colour.
- Tiling** : Full glazed tiles to Bath/ Toilets with ceramic flooring & white glazed tiles in WC.
- Kitchen** : Black granite kitchen platform with Stainless steel Sink
- Windows** : Black powder coated Aluminium sliding windows with mosquito mesh & grills.
- Doors** : Decorative main entrance door, Internal flush doors.
- Electrical** : Concealed wiring, Telephone & TV point in living room.
- Lift** : Lift facility.
- Parking** : Ample space for parking with decorative flooring.
- Others** : Well developed building premises with flower beds. Beautiful elevation with attractive colour scheme. Bore well water facility.

CREDITS

ARCHITECTS
Designers Collaborative
Tel.- 4017595

R. C. C. CONSULTANT
Sneha Associates
Tel.- 4002589

LEGAL ADVISOR
Kantilal K. Sancheti (Advocate)
Tel.- 4480497

DEVELOPERS
Namo Construction Co.
Tel.- 5534478/ 5530896